

## Tailor™ Flexible Annuloplasty Ring

### Product Highlights

- Designed to maintain the size of a repaired mitral or tricuspid annulus while sustaining physiologic movement
- Anterior and posterior support allows dynamic annular motion during the cardiac cycle
- Flexible design aids cardiac output and left ventricular function, supporting optimal hemodynamics<sup>1-3</sup>
- Large target area eases suturing
- Suitable for implant using open sternotomy, minimally invasive and robotic approaches

### Ordering Information

Contents: Flexible Ring (1 unit per box)

| Reorder Number | Ring Size | Inside Dimension (mm) | Outside Dimension (mm) | Intertrigonal Dimension (mm) |
|----------------|-----------|-----------------------|------------------------|------------------------------|
| TARP-25        | 25        | 28.4                  | 34.4                   | 25                           |
| TARP-27        | 27        | 31.2                  | 37.2                   | 27                           |
| TARP-29        | 29        | 34.0                  | 40.0                   | 29                           |
| TARP-31        | 31        | 36.6                  | 42.6                   | 31                           |
| TARP-33        | 33        | 39.4                  | 45.4                   | 33                           |
| TARP-35        | 35        | 40.9                  | 47.9                   | 35                           |

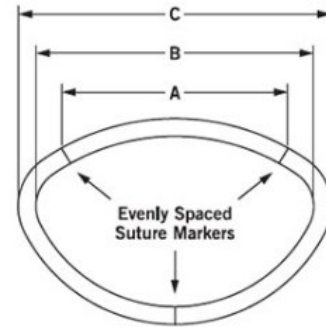
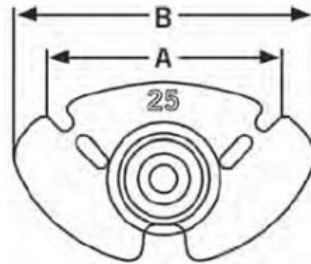

A: Intertrigonal Dimension (mm)  
B: Inside Dimension (mm)  
C: Outside Dimension (mm)

1. Yamaura Y, Yoshikawa J, Yoshida K, et al. Three-dimensional analysis of configuration and dynamics in patients with an annuloplasty ring by multiplane transesophageal echocardiography: Comparison between flexible and rigid annuloplasty rings. J Heart Valve Dis. 1995;4(6)618–22.
2. Kunzelman K, Reimink S, Cochran P. Flexible versus rigid ring annuloplasty for mitral valve annular dilatation: A finite element model. J Heart Valve Dis. 1998;7(1)108.
3. David T, Armstrong S, Sun Z. Left ventricular function after mitral valve surgery. J Heart Valve Dis. 1995;4(Supl) S175–80.

#### Rx Only

Please review the Instructions for Use prior to using these devices for a complete listing of indications, contraindications, warnings, precautions, potential adverse events and directions for use.

Unless otherwise noted, ® or ™ indicates a registered or unregistered trademark or service mark owned by, or licensed to, St. Jude Medical, Inc. or one of its subsidiaries. ST. JUDE MEDICAL, the nine-squares symbol and MORE CONTROL. LESS RISK. are registered and unregistered trademarks and service marks of St. Jude Medical, Inc. and its related companies.

©2013 St. Jude Medical, Inc. All rights reserved.

100033292 – May 2012

Customer Support: 855-478-5833

Last Updated: April 19, 2013

